

# CWB6 LIQUID SOAP DISPENSER

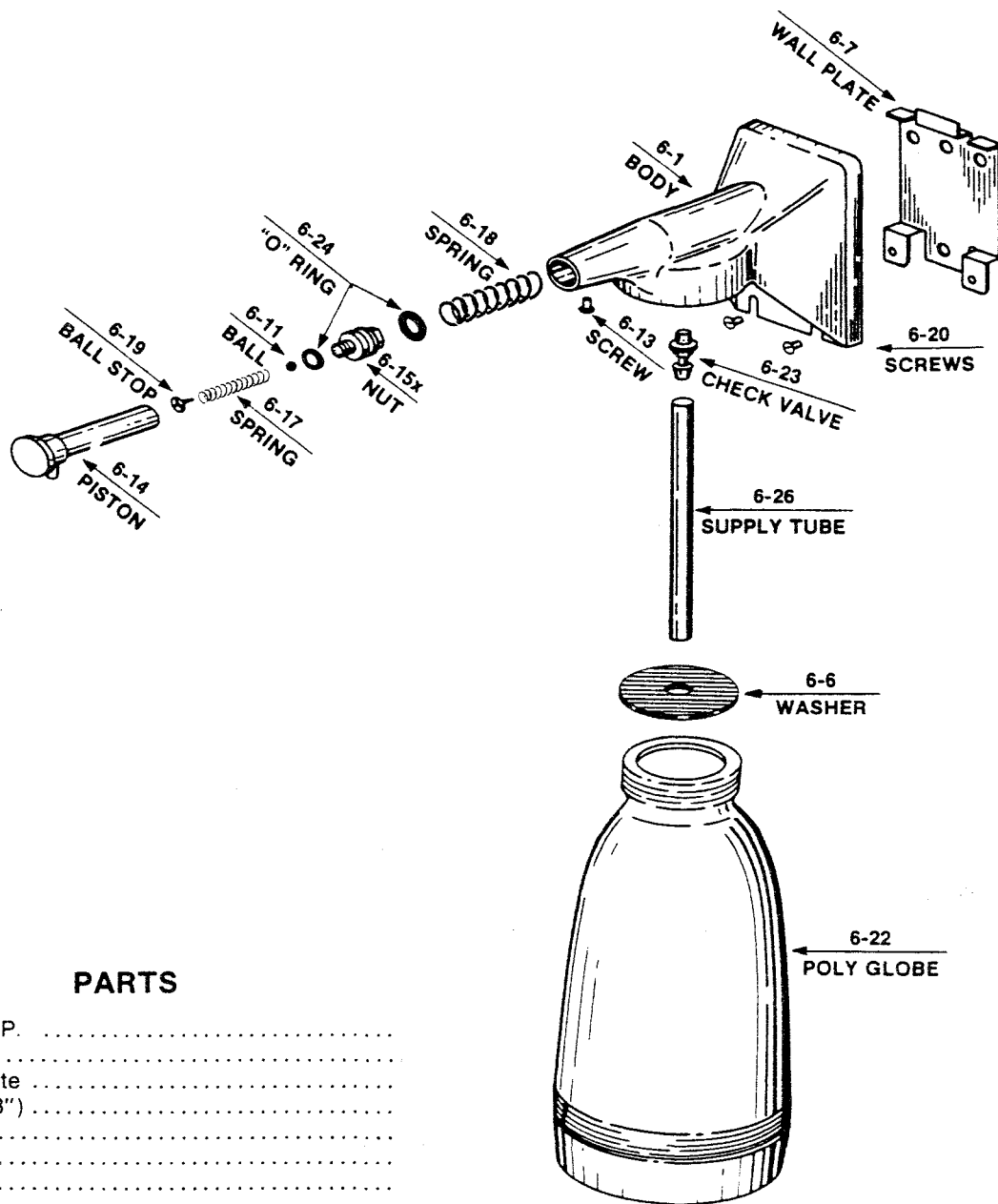

## PARTS

6-1	Body C.P.	.....
6-6	Washer	.....
6-7	Wall Plate	.....
6-11	Ball (1/8")	.....
6-13	Screw	.....
6-14	Piston	.....
6-15x	Nut	.....
6-17	Spring	.....
6-18	Spring	.....
6-19	Ball Stop (inside 6-17)	.....
6-20	Screw (set of 2)	.....
*6-22	Polyethylene Globe (16 oz.)	.....
6-23	Check valve complete	.....
*6-24	"O" Ring	.....
6-26	Polyethylene Supply Tube	.....
*6-32	Complete Piston Assembly	.....

\* Denotes stocked part

## INSTALLATION INSTRUCTIONS

The bottom of No. 6-7 Wall Plate should be 8" above the lavatory. Use Rawlplugs for tile and marble walls. For plaster walls, use two Toggle Bolts in the two center holes of the wall plate.

Force the dispenser down over the Wall Plate until the bottom of the dispenser is even with the bottom of the Wall Plate. Tighten the No. 6-20 screws to secure the dispenser to the Wall Plate.

TO PRIME the pump, move the Piston in. On the outward stroke hold a finger over the Spout. Release finger on the inward stroke.

TO REPLACE 6-24 "O" RING: Remove 6-13 set screw and piston assembly, part 6-32. Remove old "O" Ring and replace with new ring. Apply small amount of petroleum jelly to ring and insert piston into cylinder with TWISTING motion. Replace set screw. DO NOT EXERT EXCESSIVE TORQUE TO 6-13 SET SCREW WHEN REASSEMBLING PISTON.

This dispenser will wear indefinitely if you will but keep it clean! A little liquid soap on a wet cloth is your best polishing agent. CLEAN THE SPOUT EVERY DAY to prevent soap from accumulating.

**Cweco**  
Commercial Washroom Equipment Company Incorporated

P.O. Box 2456, Gardena, CA 90247-0456 310-538-9440

1-800-292-9326 Outside CA FAX: 310-715-9188

FAX 1-800-232-9326